

APD Procedures

Connection procedure for *stay•safe*TM PIN technology

Important: With this and all Peritoneal Dialysis procedures, always maintain aseptic technique.



Set up your cyclor and prime the tubing set. Mask and wash your hands.



Place the top of the tubing set patient connector in the organizer clip.

Disconnection procedure for *stay•safe*TM PIN technology



Place a new *stay•safe*TM cap in one of the organizer notches.



Turn the blue trigger on the patient connector clockwise to unlock.



Roll the connector to the side to fully position it in the clip. Press the tubing into the channel of the organizer.



Close the extension set clamp. Place the end of your extension set in a notch of the organizer.



Press the blue trigger on the patient connector forward until it stops. This will release the pin into the catheter extension set.



Place the patient connector with attached catheter extension in the organizer. Close the clamp on your extension set.



Unscrew the protective cover from the tubing patient connector.

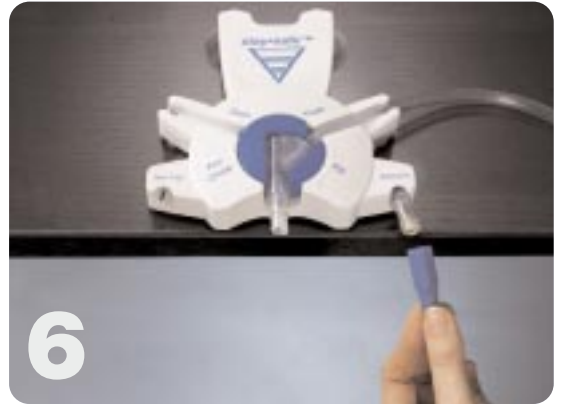

Unscrew the catheter extension from the **stay•safe™** cap.



Remove the protective cover from the **stay•safe™** cap.



Unscrew the extension set from the patient connector.



Connect the catheter extension to tubing connector.



Place the protective cover from the patient connector on the used **stay•safe™** cap. Remove and discard the cap. Open the catheter extension clamp and start your treatment.

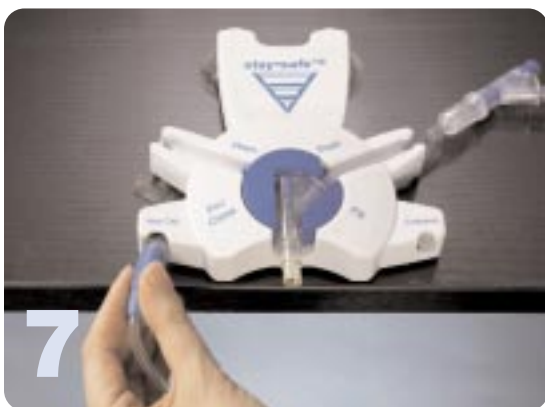

Connect the extension set to the **stay•safe™** cap.



Place the protective cover from the **stay•safe™** cap on the patient connector. Remove the connector from the organizer. Discard tubing and effluent as instructed by your facility.

APD Procedures

"Pause" procedure for *stay•safe™* PIN technology

Important: With this and all Peritoneal Dialysis procedures, always maintain aseptic technique.



After filling, the cycler will automatically be "Paused".



Place a new *stay•safe™* cap in one of the organizer notches.



Place the protective cover from the *stay•safe™* cap on the patient connector. Remove the connector from the organizer. Place the patient line into the tubing guide on the side of the cycler.



When it is time to continue after "Pause" phase, press "Start". Mask and wash your hands.



Turn the blue trigger on the patient connector clockwise to unlock.



Press the blue trigger on the patient connector forward until it stops. This will release the PIN into the catheter extension set.



Insert the second patient connector into the organizer.



Close your extension set clamp. Place the end of your extension set in a notch of the organizer.



Place the patient connector with attached extension set in the organizer. Close the clamp on your extension set.



Remove the protective cover from the **stay•safe™** cap.



Unscrew the first patient connector from the tubing set.



Unscrew the catheter extension from the **stay•safe™** cap.

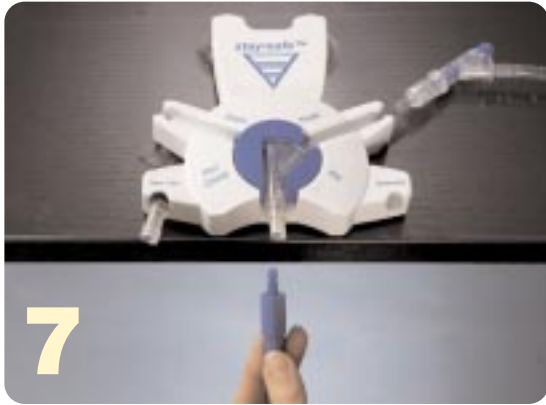

Unscrew the extension set from the patient connector.

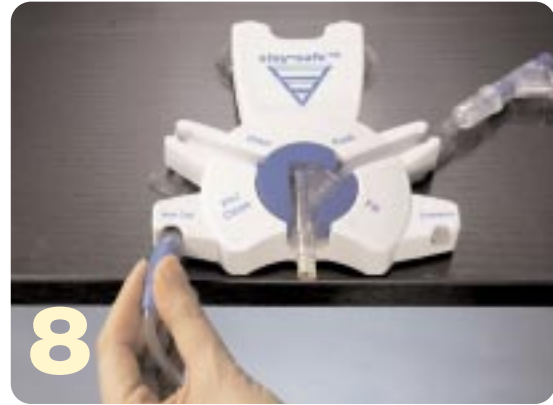

Connect the extension set to the **stay•safe™** cap.



Connect the catheter extension to the tubing connector.



Open your catheter extension clamp and continue with your treatment. Remove the connector and extension set from the organizer.

For all cyclor inquiries or questions, please contact Technical Services at 800-227-2572.

